

Village of Denmark, WI Street & Utility Improvements

North Wall Street (CTH T), Hansen Street & Pine Street



The Denmark Street and Utility Projects are Starting!

Please note that a **Web Page** for this Project has been established. To get current information about the project, go to www.mcmgrp.com and under the “**RESOURCES**” Dropdown, select “**IN CONSTRUCTION**” and then the **North Wall Street (CTH T)** graphic. You may also select the bulldozer icon on the right side of the screen to get to the **IN CONSTRUCTION** screen.

PROJECT SCHEDULE: **START: April 8, 2019** **END: September 6, 2019***

*Final asphalt pavement surface to be completed in Spring of 2020

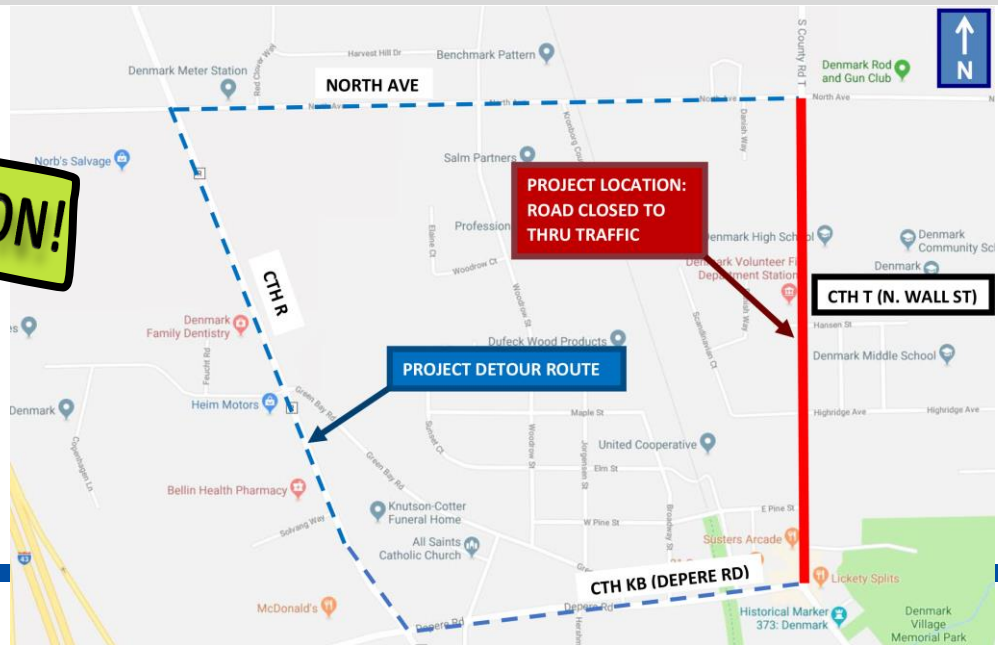

TRAFFIC:

North Wall Street (CTH T) will be closed to through-traffic with a detour route provided by Brown County Highway Department. The detour map can be found on the Project Webpage. North Wall St, Hansen St. and Pine St. will remain open to local traffic, emergency vehicles, school buses and recycling vehicles during construction.

The Pine St. intersection may be closed for a total of two weeks to allow for the utility installations. The webpage will be updated weekly and will include advance-notice of this closure. Access will be provided during this period on North Wall St. from the north or south but it will not be possible to drive through the project from DePere Rd. to North Rd. Access to Hansen St., Highridge Ave. and Scandinavia Ct. will be provided from the north during the Pine St. intersection closure.

Access to Pine St. will be via Broadway St. and Railroad St. for the two-week Pine and North Wall intersection closure.

Access will be provided for businesses, schools and the Fire Dept. at all times. Residential driveway access shall be maintained at all times except when work is occurring at or immediately adjacent to the driveways. The contractor will coordinate with each property owner a minimum of 24 hrs. in advance of any driveway access interruption. Residential driveway access interruptions will be kept to a minimum and access shall be restored at the end of each workday with the exception of during the 21-day calendar-day construction and cure-time for driveways, sidewalk and curb and gutter. Residents can park on adjacent sideroads or make other parking arrangements during this time period.

TWITTER:

A Twitter Account for this project is set up to allow you to gain access to the latest pertinent construction information. Just go to twitter.com/McMNorthWallSt to view the latest “tweets” from our on-site project representatives. If you currently have a Twitter Account, you may choose to **FOLLOW** this project or you can create one with a User ID and password. Note: There is also a Twitter Feed embedded into the Project Page of the McMAHON website so you can also view it there.

Questions about the project can be directed to the Village of Denmark DPW, Erika Sisel, Village Engineer Mick Magalski or Shane Kelliher. Contact information for them can be found on the Project Webpage.

For more information, visit www.mcmgrp.com/resources/construction-project-updates/